

Emergency Evacuation Map

In an Emergency call 911 for Police, Fire and Medical Assistance

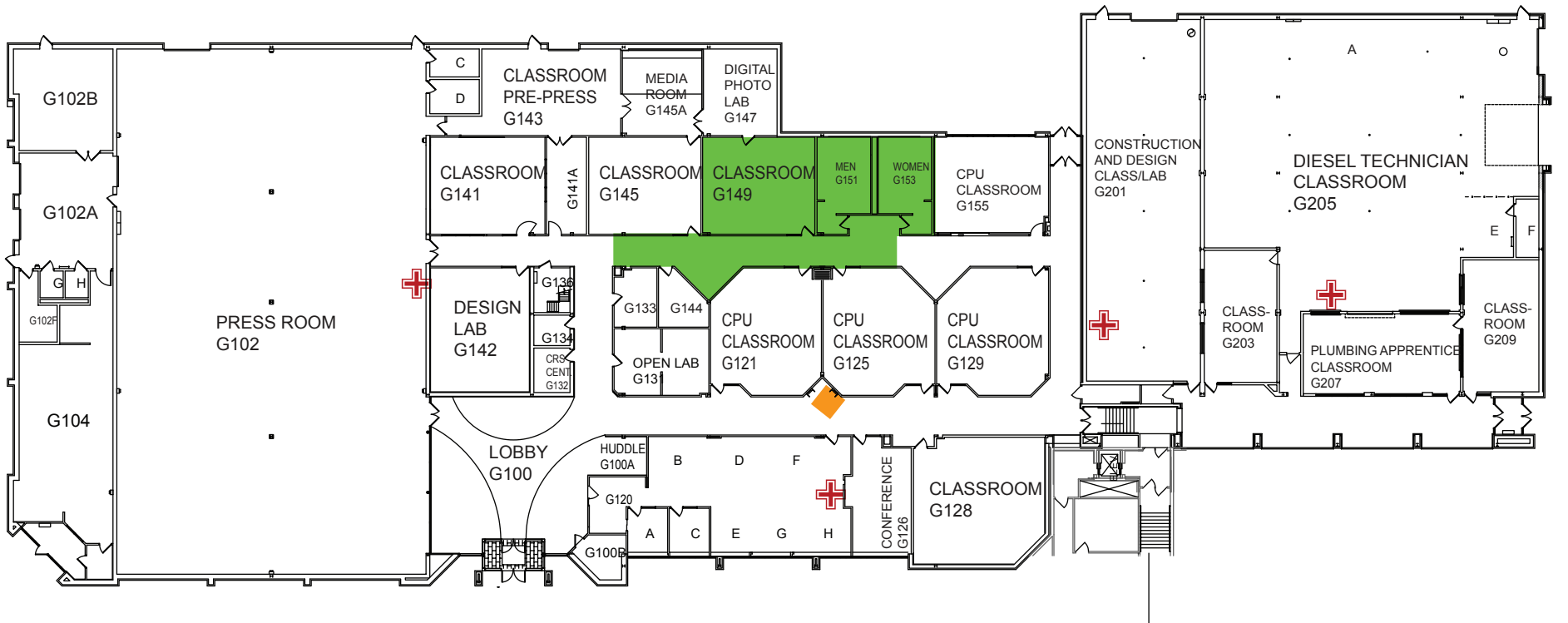

BUILDING G
 EVACUATION STAGING AREA:
 Light Post #11

In case of fire use stairs
 DO NOT use elevators



KEY

- Shelter Areas
- AED Locations
- You Are Here
- + First Aid Kit
- Stair Chair

BUILDING G